

4-LINE TO 5-LINE CONVERSION STEPS - CONTROL SYSTEM

THE AMP SHIPS STANDARD IN 4-LINE BRIDLE MODE. A SIMPLE CONVERSION IS REQUIRED TO THE KITE AND CONTROL SYSTEM FOR 5-LINE MODE.

- Included with each AMP kite is a 5-Line Conversion Kit (specific to the kite size) containing 1x Y-bridle and 2x A5 Pigtails.
- Line no.5 (5th line) is required for the control system to use the AMP in 5-Line mode, this can be ordered separately, contact your dealer/shop for more info.

CONVERSION HOW TO VIDEO AVAILABLE ONLINE

www.ozonekites.com/products/water-kites/amp-v1/#video

4-LINE MODE

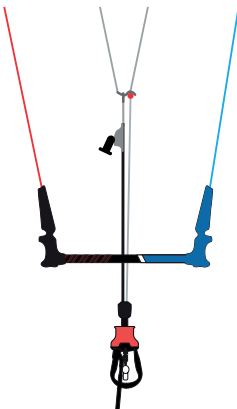

5-LINE MODE

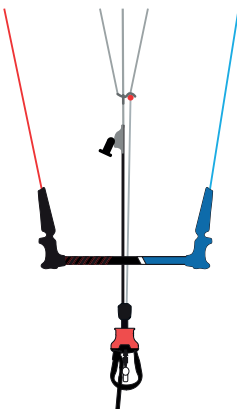

CONTROL SYSTEM - ATTACH LINE NO.5

NOTE: Line no.5 is a support line. Line no.3 remains as the flag out line.

- Prepare the control system - unwind all lines and remove twists.
- Unwind line no.5 from the plastic winder.
- Feed bottom end of line no.5 down through the Stainless Steel trimmer bracket, and around the screw.
- Feed line no.5 back up through the trimmer bracket.
- The line should be around the screw as shown.
- Feed the top end of line no.5 through the bottom end loop.
- Pull the line all the way through.
- Pull tight against the trimmer bracket screw.
- Your Control System is now ready to be used in 5-Line mode.
- To convert back to 4-Line mode, disconnect line no.5 simply by reversing the steps shown. Store the line on the plastic winder.

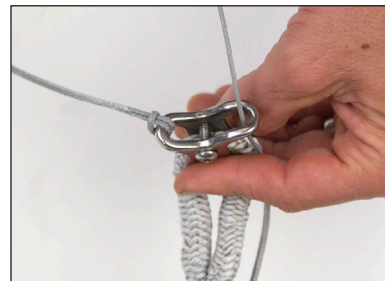

4-LINE TO 5-LINE CONVERSION STEPS - KITE

KITE - CONVERT TO 5-LINE MODE

(disconnect 4-line bridle, then connect 5-line pigtails & bridle)

- Disconnect all front grey bridle lines on both sides of the kite (Front line pigtails 1 & 2, A4, A3, A2, A1, AL1, AL2)
- Disconnection order: front line pigtail -> AL2 -> AL1 -> A1 -> A2 -> A3 -> A4
- Connect each bridle line to the front line pigtail to avoid losing them. Repeat for the other side.
- The A1 Pigtails and KL bridle lines (rear bridles) stay attached.
- Connect the A5 Pigtails to the A4 tabs (left and right side)
- Connect the Y-bridle. The two equal lines attach to the ends of A1 pigtails (left and right side)
- Your kite is now ready to be used in 5-Line mode.

4-LINE BRIDLE MODE

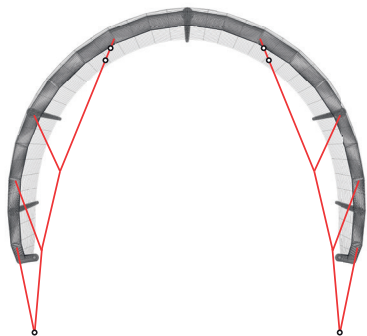

5-LINE MODE

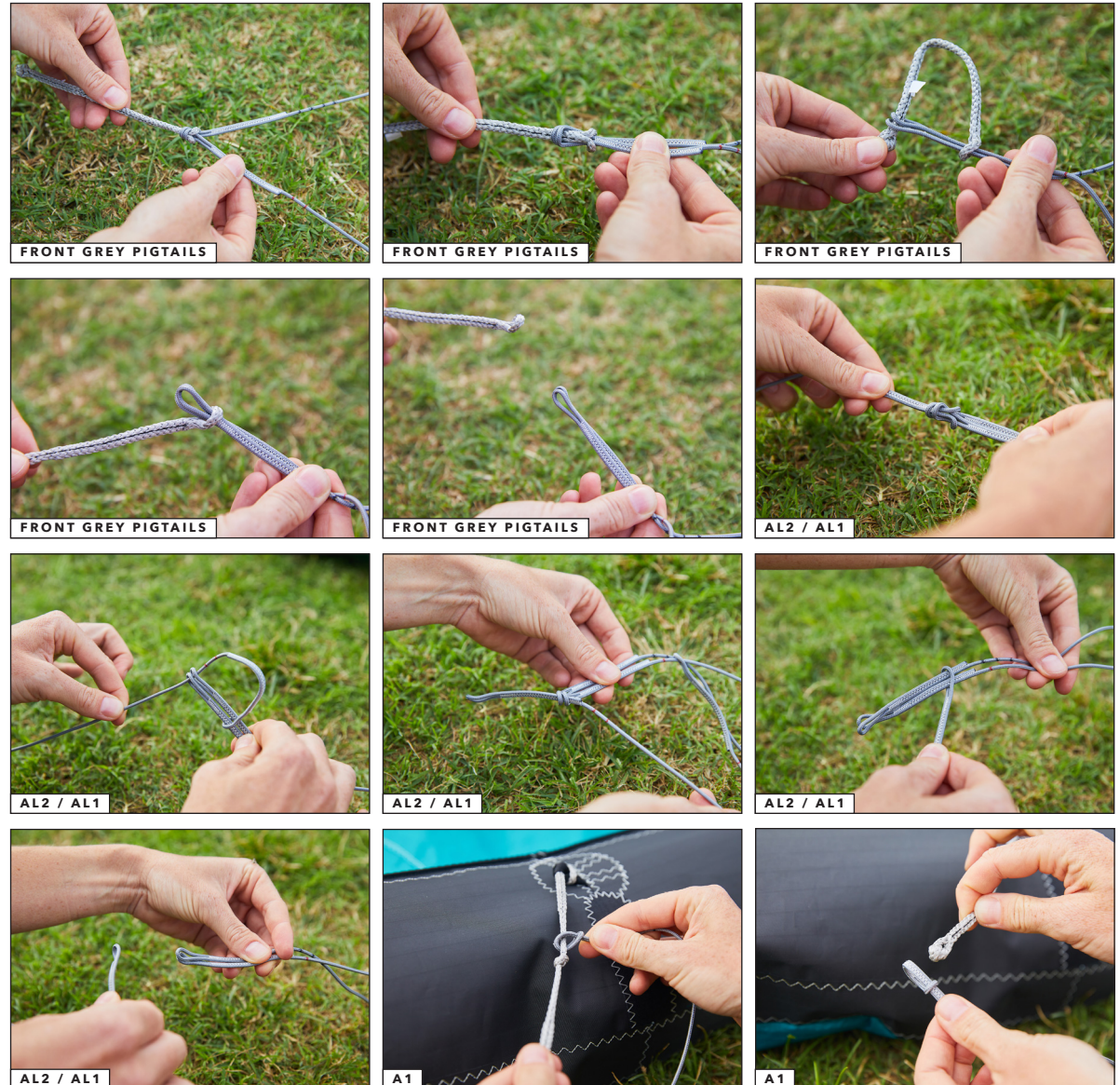
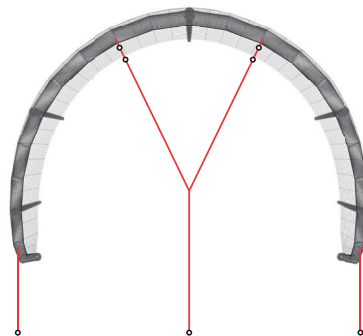

CONTINUED >>

4-LINE TO 5-LINE CONVERSION STEPS - KITE CONTINUED

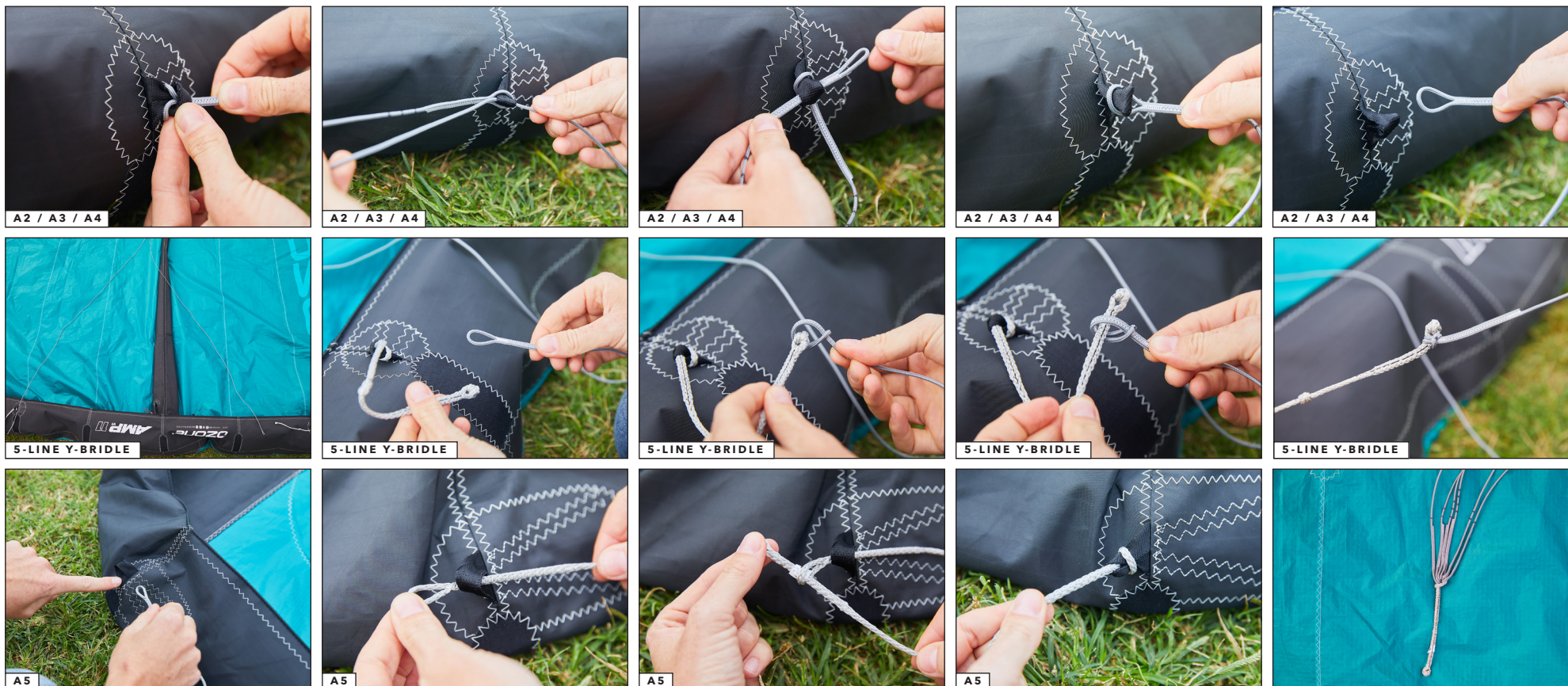

KITE - CONVERT BACK TO 4-LINE MODE

(disconnect 5-line bridle and pigtails, then connect 4-line bridle)

- Disconnect the 5-Line Y-bridle. Disconnect the two A5 Pigtails.
- The 4-Line bridles are marked with a reference code. This makes it easy to identify each bridle line when re-connecting.
- You can also use the BRIDLE CHECK SHEET on the next page to measure and identify each bridle.
- Undo the 4-Line bridles from the grey pigtail, identify each line and connect to the kite.
- A4, A3, and A2 connect onto the webbing tabs.
- A1 connects to the A1 pigtail already on the kite.
- After connecting A1-A4, connect the linking bridles AL1 and AL2, then the front line pigtail.
- Repeat for the other side of the kite. Your kite is now ready to be used in 4-Line mode again.

LINE MARKING

THE 4-LINE BRIDLES ARE MARKED WITH A REFERENCE CODE. THIS MAKES IT EASY TO IDENTIFY EACH BRIDLE LINE WHEN RE-CONNECTING.

A1 = I
A2 = II
A3 = III
A4 = IIII
AL1 = I
AL2 = II



CHECKING BRIDLES FOR STRETCH OR SHRINKAGE

WE RECOMMEND YOU REGULARLY CHECK YOUR KITES
BRIDLES TO KEEP YOUR KITE FLYING AT TOP PERFORMANCE.
USE THE MEASUREMENTS TO CHECK YOUR BRIDLE LENGTHS.

RECOMMENDATIONS

- Open your kite in a large space, big enough to spread your kite out fully.
- Use a tape measure to measure the bridles.
- Print out the sheet and write down any differences.

If your bridles are out by more than 20mm we recommend replacing them,
please get in touch with the shop/dealer you purchased the kite from and they
can order individual bridle lines or a full set if they do not already have stock.

AMP V1 RIGGING DIAGRAM

YELLOW = 4-LINE BRIDLE MODE

GREEN = 5-LINE MODE

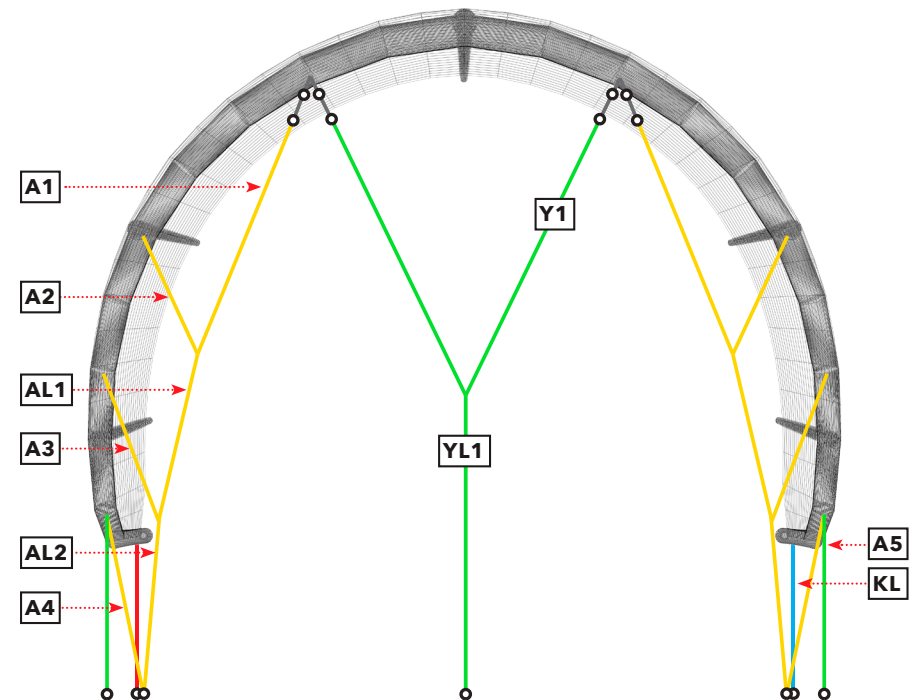

BRIDLE CHECK SHEET. ALL MEASUREMENTS IN MM

LINE NO.	7M	9M	11M	13M	15M
A1	930	1070	1240	1355	1505
A2	480	540	595	640	705
A3	630	705	780	845	925
A4	775	875	960	1035	1135
AL1	665	750	830	895	980
AL2	710	800	880	950	1040
KL	510	570	645	700	750
A5	930	1035	1170	1200	1290
Y1	1300	1560	1620	1750	1910
YL1	960	1050	1360	1455	1590