



OZONE
Ignition Manual

THANKS

Thank you for purchasing this Ozone kite. Our mission is to build kites with cutting edge performance, that are easy, fun and safe to use, no matter what your level.

At Ozone we are passionate about kiting, and it is this passion that drives our design team to perfect and develop new kites that we love to ride with.

We are proud of the quality of our products, and constantly searching for the best components and materials to use in our designs. All of our kites and accessories are manufactured in our own high-quality production facility in Vietnam, which guarantees a build quality that we are proud to put the Ozone name on. A close look at one of our kites reveals that same superior quality and construction that ensures that every Ozone kite will enjoy a long life, with consistent handling, performance and aesthetics.



FRA : POUR TÉLÉCHARGER CE MANUEL DANS VOTRE
LANGUE, ALLEZ SUR LE PAGE DU PRODUIT ET
CHOISISSEZ VOTRE KITE >> WWW.FLYOZONE.COM

ESP : PARA DESCARGAR ESTE MANUAL EN SU IDIOMA
DIRIJASE A LA PÁGINA DEL PRODUCTO DEL
MODELO DE SU COMETA >> WWW.FLYOZONE.COM

ITA : PER SCARICARE QUESTO MANUALE NELLA VOSTRA
LINGUA, ANDATE ALLA PAGINA PRODOTTI DEL KITE IN
VOSTRO POSSESSO >> WWW.FLYOZONE.COM

DE : UM DIESE ANLEITUNG IN DEINER SPRACHE HERUNTER
ZU LADEN, GEHE AUF DIE PRODUKTSEITE DES KITES,
WELCHEN DU BESITZT >> WWW.FLYOZONE.COM

WARRANTY

Ozone warrants this product to be free from major defects in material or workmanship to the original purchaser, for a period of six months from the date of purchase.

This warranty is subject to the following limitations;

- The warranty is valid only when the product is used for its intended use, and does not cover products used in rental or teaching operations.
- Ozone will make the final warranty determination, which may require inspection and/or photos of the equipment, which clearly show the defect(s). If necessary, this information must be sent to the Ozone dealer, postage prepaid.
- If a product is deemed to be defective by Ozone, the warranty covers the repair or replacement of the defective product only.
- Ozone will not be responsible for any costs, losses, or damages incurred as a result of loss of use of this product. The warranty does not cover damage caused by misuse, abuse, neglect or normal wear and tear including but not limited to; rigging with other than Ozone components, damage due to excessive sun exposure, damage caused by improper handling or storage, damage caused by use in waves or shore break and damage caused by anything other than defects in material and workmanship.
- This warranty is voided if any unauthorized repair, change or modification has been made to any part of the equipment. The warranty for any repaired or replaced equipment is good from the date of the original purchase only. The original purchase receipt must accompany all warranty claims.
- The name of the retailer and date of purchase must be clear and legible.
- There are no warranties that extend beyond the warranty specified herein.

WARRANTY CLAIMS

- Warranty claims can only be handled once the product has been activated through our website. (go to www.flyozone.com to register your kite)
- Warranty claims must be processed and be issued a return authorization prior to shipping to the Ozone dealer the product was purchased from.

RELEASE OF LIABILITY

OZONE KITES LTD RELEASE OF LIABILITY, CLAIM WAIVER, ASSUMPTION OF RISK

By assembling and/or using this Ozone product, you agree that you have read and understood the entire Ozone product owners manual, including all instructions and warnings contained in that manual, prior to using the Ozone product in any way. You additionally agree that you will ensure any additional or subsequent user of your Ozone product will read and understand the entire Ozone product owners manual, including all instructions and warnings contained in that Manual, prior to allowing that person to use your Ozone product.

ASSUMPTION OF RISK

Use of the Ozone product and any of its components involve certain risks, dangers, and hazards which can result in serious personal injury and death to both the user and to non-user third parties. In using this Ozone product, you freely agree to assume and accept any and all known and unknown risks of injury to you and third parties while using this equipment. The risks inherent in this sport can be greatly reduced by abiding by the warning guidelines listed in this owner manual and by using common sense.

RELEASE AND WAIVER OF CLAIMS

In consideration of the sale of the Ozone product to you, you hereby agree to the fullest extent permitted by law, as follows:

TO WAIVE ANY AND ALL CLAIMS that you have or may in the future have against Ozone Kites LTD and all related parties resulting from use of the Ozone product and any of its components.

TO RELEASE Ozone Kites LTD and all related parties from any and all liability for any loss, damage, injury or expense that you or any users of your Ozone product may suffer, or that your next of kin may suffer, as a result of the use of the Ozone product, due to any cause whatsoever, including negligence or breach of contract on the part of Ozone Kites LTD and all related parties in the design or manufacture of the Ozone product and any of its components.

In the event of your death or incapacity, all provisions contained herein shall be effective and binding upon your heirs, next of kin, executors, administrators, assigns, and representatives. Ozone Kites LTD related parties have not made and expressly deny any oral or written representations other than what is set forth herein the Ozone Product Users Manual.

WARNINGS

READ THE FOLLOWING POINTS BEFORE ASSEMBLING YOUR KITE:

WARNING:

- Kite flying can be dangerous.
- Always use extreme caution when using this product.
- Misuse of this product can cause serious injury or death.
- Only use this product if you are in good physical health.
- Never act in a careless manner when using this product (such as jumping in the air, or tying yourself down).
- You are responsible for your own safety, and the safety of others around you when using this product.
- If you are under 18 you should have your parents or legal guardian read these warnings and instructions. You should not use this product unless you are under proper guidance and supervision.
- The use of this product exposes the user to many unavoidable and unexpected risks, dangers and hazards.
- Do not use this product if you are under the influence of alcohol, drugs or medications.
- This manual refers to the current product it comes with. No information contained herein applies to previous and/or other products. Always read and understand all warnings and instructions for any other product being used. To view previous product manuals go to www.flyozone.com

IMPORTANT RULES:

- Before using this product you must take lessons from a certified instructor/school. Do not attempt to fly a kite without being taught by a certified kite instructor.
- This product is not a personal flotation device. Always wear a Coast Guard approved personal flotation device when using this product near the water.
- Always carefully inspect all of your equipment before using it.
- Always have a partner when launching and landing your kite.
- Always learn using a small two line trainer kite before using a larger more complicated kite.
- Never allow anyone who is not familiar with traction kiting to use this product without experienced assistance.
- Never use this product without a kite leash system. A loose kite is extremely dangerous to everyone downwind.
- The kite/control system is equipped with passive release systems, which need to be activated by the user for them to work.
- The leash system is not a permanent attachment to this product. Never permanently attach yourself to the kite or any of its components.
- Never use this the kite with another control system or kite leash. Only use the control system that is supplied with this kite as other brands are not compatible with this design, therefore the release system will NOT work.

- Always wear a helmet when using this product.
- Always use a high quality and well maintained kite specific harness.
- Get yourself used to the way your quick release devices work by testing them often in a non emergency situation.
- Rinse your quick release device in fresh water after every session. Quick release devices have a limited lifetime and must be checked and replaced often.
- Always release and re-load all the release systems to familiarize yourself with how they work. This is the only way to be sure that you know how to use them in all situations, and that they are correctly loaded and safe for use.
- If you have a bar with a mechanical quick release trim loop it must be changed after 150 hours of kiting. Change any quick release or kite leash before if you see any sign of wear. The wearing of your quick release devices is not considered a warranty issue.

CHOOSE SAFE WEATHER CONDITIONS:

- Never learn to use this product in more than 10 knots of wind.
- We highly recommend you purchase a wind speed indicator to be able to measure wind speeds. Study the wind guide to understand wind speeds.
- Never use this product in high winds.
- Never use this product in thunderstorm and lightning conditions.
- Only use this product when you can remain in a standing position.
- Never use this product in wind conditions that are above your ability level.
- Never use this product near or on the water in offshore wind conditions.



CHOOSE A SAFE LOCATION:

- Always observe local rules and regulations when using this product.
- Never use this product near power lines, telephone poles, trees, bushes, roads, automobiles or airports.
- Only use this product when you have at least 100m of clear space downwind, and on both sides of your launching position. The power of the kite can pull you downwind unexpectedly with great force.
- Do not fly your kite over other people or pets. Spectators should remain upwind of you when using this product.
- Never use this product on crowded beaches or fields.
- Never use this product near the water unless you know how to swim and are in good physical health.
- Practice launching and landing procedures, and self rescue techniques before using this product near the water.

USE CAUTION WITH FLYING LINES:

- Never touch the flying lines when the kite is in use. Flying lines are extremely dangerous while under tension and can cause serious injury or death.
- Never use this product with worn lines. A line that breaks while under tension can cause serious injury or death.
- Always check your flying lines for knots before each use. Knots greatly reduce the strength of the lines.
- Stay away from tangled flying lines unless the kite is secured to the ground. An unsecured kite can self launch unexpectedly, and can cause serious injury or death.
- Never allow yourself, or anyone else, to get between the control bar and the kite when using this product.

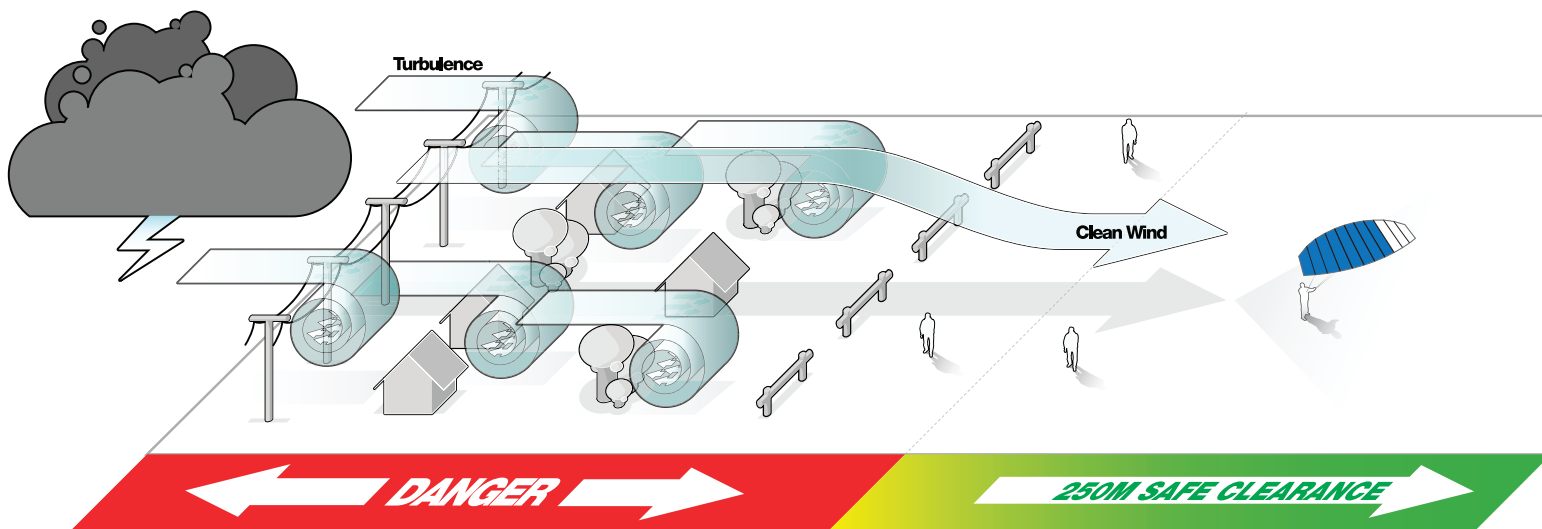

WIND

FORCE	KNOTS	MPH	METRES/SEC	KPH	DESCRIPTION	SKILL LEVEL	ON LAND
0	<1	<1	<0-0.2	<1	Calm	N/A	Calm, smoke rises vertically. Go paragliding/base jumping/hang-gliding
1	1-3	1-3	0.3-1.5	1-5	Light Air	N/A	Smoke drift shows wind direction. Its coming-get large size kites ready!
2	4-6	4-7	1.6-3.3	1-5	Light Breeze	Beginner	Wind felt on face, leaves rustle. Cruising on Mt board/buggy/snowkite
3	7-10	8-12	3.4-5.4	12-19	Gentle Wind	Beginner	Leaves in motion, light flags extended. Ripping on Mt board/buggy/snow
4	11-16	13-18	5.5-7.9	20-29	Moderate Wind	Intermediate	Flags flap, small branches move. Now we're talking->jumping begins
5	17-21	19-24	8.0-10.7	30-38	Fresh Wind	Advanced	Small trees begin to sway. Loving life, fully powered, smiling
6	22-27	25-31	10.8-13.8	39-50	Strong Wind	Advanced	Large branches in motion. Experts only with huge grins
7	28-33	32-38	13.9-17.1	51-61	Near Gale	Advanced	Whole trees in motion . Hard core riders flying!
8	34-40	39-46	17.2-20.7	62-74	Gale	N/A	Trouble walking! Carnage for riders, better to chill out in comfort watching Ozone DVD

↗ always launch your kite at the edge of the wind window

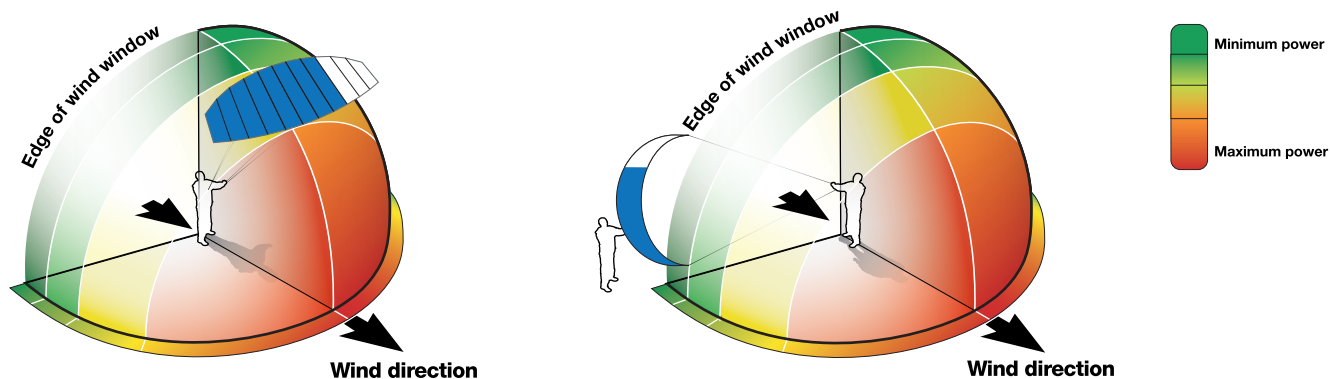

SET-UP

➤ ALL LINE TO KITE CONNECTIONS ARE MADE USING A "LARKS HEAD" KNOT.

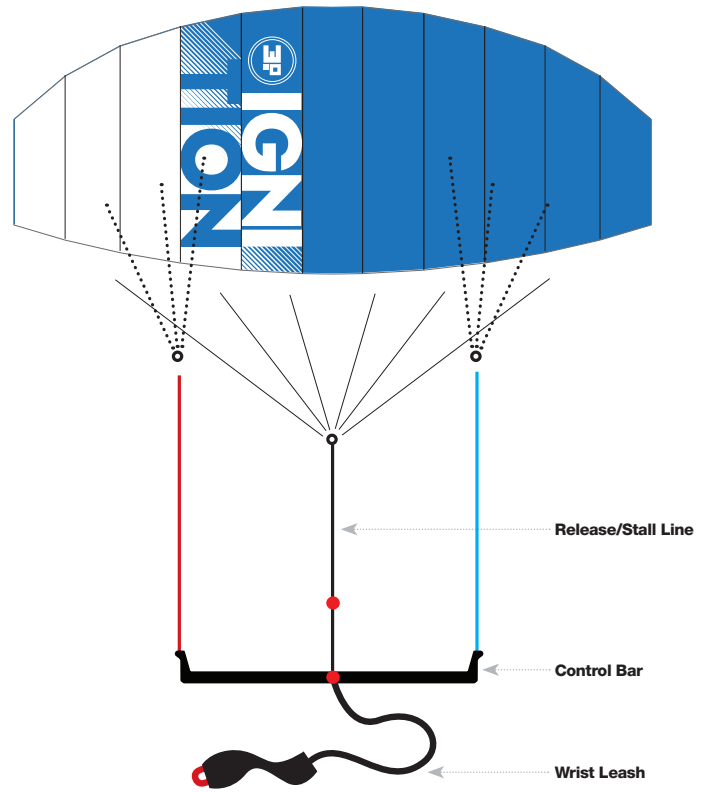
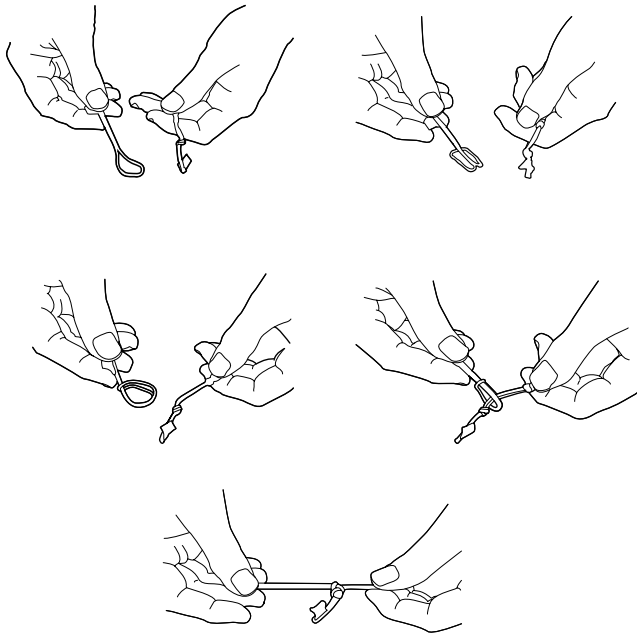

SET-UP

WARNING: Children should only use kites under competent supervision and in light winds. Build up your skill level and confidence slowly and learn to kite in the correct wind conditions and area. There should be no obstacles within 400m downwind of the kiter, and until you are skilled only kite in winds less than 12kph. See wind diagram and descriptions page. Never fly your kite in strong wind for the 1st time. Set up your kite in wind less than 12kph to ensure your and the safety of others. See wind diagram.

KITE SET-UP

Once you've chosen a safe place to kite, you will need to set up the different parts of your kite before using it.

Take the kite out of the bag and unfold it on the ground with the trailing edge facing into the wind. Put some sand or snow on the trailing edge or on one tip if launching at the edge of wind window. Take the bridle connector loops from the velcro keeper.

Make sure there are no twists in the kites bridles.

Un-wind the lines and remove any twists. If lines are un-connected, connect them using the "larks head" knot.

Connect the lines on the kite following the line label system (1 to 1, 2 to 2 and 3 to 3).



1



2



3



4

SECURITY

WARNING: All Ozone release systems require the user to operate them manually in the case of an emergency. It is imperative the kite is set-up as shown in the manual, incorrect setup will compromise the operation of the release system. All lines must be tangle free and the wrist leash connected in the right way, see pictures.

This kite is equipped with a wrist leash release system. To engage the wrist leash simply let go of the control bar. The kite will loose power and stall down to the ground. Practise using the wrist leash release system until you are 100% confident.

PRIMARY RELEASE



1



2



3



4

1st FLY

1ST FLY - LAUNCH AND FLYING

OPTION 1: Launch the kite at the side of the wind window with a friend holding the leading edge.

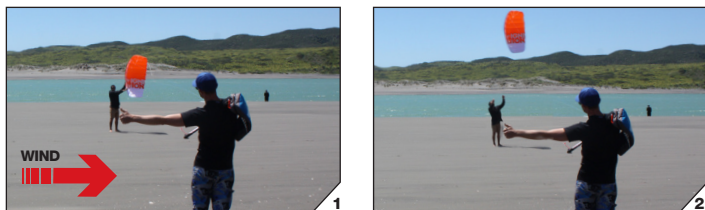

OPTION 2: Take a few paces back and the kite will start to inflate and take off. See wind diagram and wind description page.

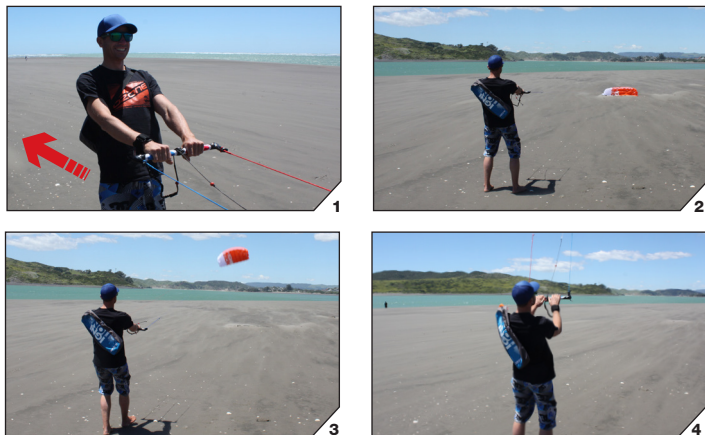

Use smooth inputs to change direction with both arms outstretched. You turn the kite by altering the distance between the lines. To turn you use the same technique as if you were riding a bike, pull the left side towards you and push your right hand away to turn left, then do the opposite to turn right.

1ST FLY - LANDING

OPTION 1: Fly the kite to the edge of the wind window, and have a friend grab the leading edge of the kite. Make sure they know NOT to take hold of the lines. They should grab only the sail material.

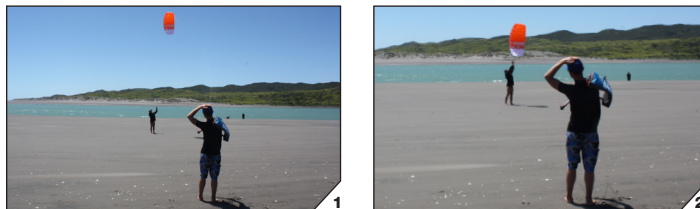

OPTION 2: You can also stall the kite by applying the wrist leash line. With practice you can land the kite exactly where you want it.

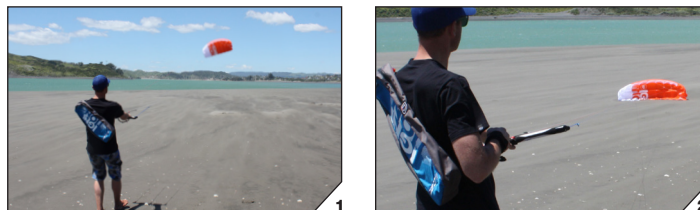

1st FLY

7 REVERSE RELAUNCH

Take the wrist leash line, and pull it until you see the kite reversing. As the kite reverses off the ground, keep holding the wrist leash line and turn the bar at the same time. This helps flip the kite over ready to re-launch.

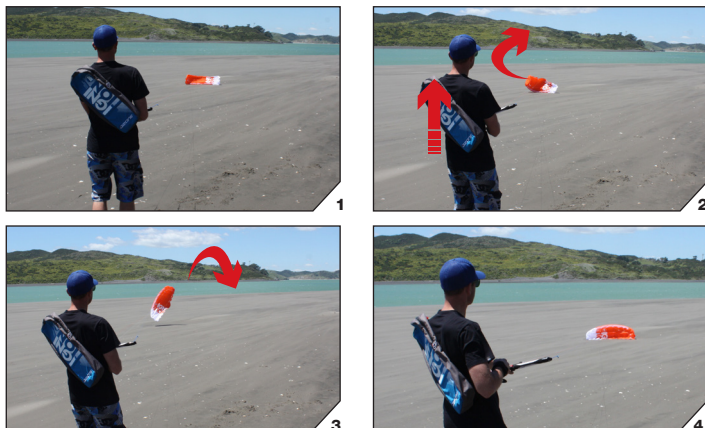

7 SECURE THE KITE WITH THE GROUNDSTAKE ACCESSORY



We recommend purchasing the Groundstake accessory as it makes ground handling, securing the kite and packing much easier. Contact your local shop/dealer.

To secure the kite using the Groundstake, stall the kite down using the wrist leash line, and hook the wrist leash around the Groundstake handle. This will keep the kite stalled down on the ground.

PACKING



IMPORTANT: To avoid a line-nightmare make sure you are meticulous with winding away your lines tightly on the bar. Wind away your lines carefully to avoid tangles! Lines can damage very easily, treat them with respect.

7 PACKING

WITH OPTIONAL GROUND STAKE ACCESSORY:

Land/secure the kite using the wrist leash release, attach the wrist leash around the secured ground stake. Walk to the kite, take one end into the wind. Place the bridles inside the kite and use the velcro keeper to secure lines in place. Fold the kite tip on tip, then roll to the centre. Walk back to the control bar kite the kite, secure the kite while wrapping the lines in a figure 8 around the bar ends, use the elastic line retainers to keep them held in place. Also loop the wrist leash around the bar end. Roll the kite up with the bar inside to fit into the carry bag.

WITHOUT GROUND STAKE:

Have a friend land your kite and secure it. Once your kite is landed and secured, wrap the lines in a figure 8 around the bar ends until you reach the kite. Use the elastic line retainers to keep them held in place. Also loop the wrist leash around the bar end. Place the bridles inside the kite and use the velcro keeper to secure lines in place. Fold the kite tip on tip, then roll to the centre. Roll the kite up with the bar inside to fit into the carry bag.

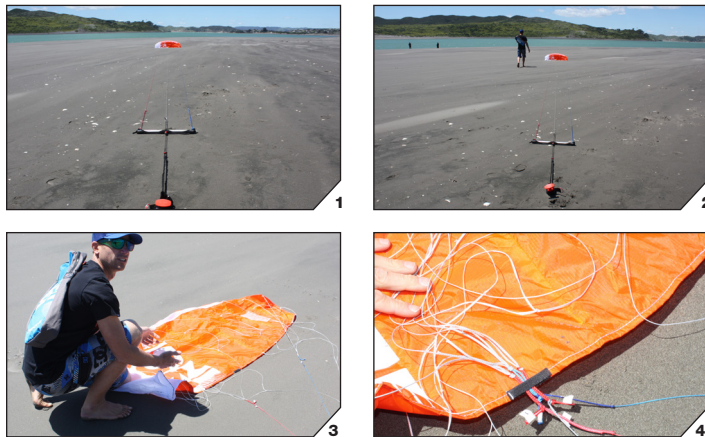



5



6



13



14



7



8

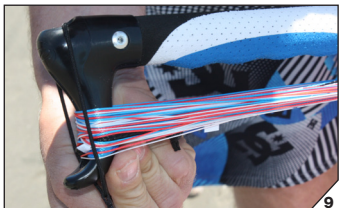

9



10



11



12

CARE & MAINTENANCE

Dry your kite after use away from the sun and direct heat. Never Leave a wet kite in its bag. Store your kite in a dry place out of the sun. Never wash or clean it with detergent. Always ensure your kite is stored completely dry.

It is imperative that you inspect all you equipment before and after every use. Immediately replace any worn or damaged parts with original parts only. A major failure could lead to serious injury or death.

PRE AND POST USE CHECK LIST

- **Lines:** check them every time you wind and unwind the line. If one of them is damaged, change the corresponding pair.
- **Bridle Lines:** check no lines are damaged. If so, contact your dealer and change them.
- **Sail:** check there are no holes or tears in the sail. If your sail is torn, you can repair it with the sticky cloth, provided in repair kit.

To repair the sail, make sure it is clean and prepare a piece of sticky cloth for the damaged area. The patch should cover the hole by at least 2cm all round. Lay flat and stick on.

